

ELECTRONIC FLOW METER

eFlo 2.0

eFlo 2.0 is an electronic flow measurement instrument used to display and control the flow of gases and liquids. With simple compatibility with existing controls, tracking and monitoring gas flows has never been easier. Designed for use in the harshest industrial environments, eFlo allows for easy replacement of manual flow meters and seamlessly integrates into existing control systems.

Features:

- Integrated communication via Modbus over RS485 (RTU) and Ethernet (TCP)
- Pressure and temperature compensation for precise flow calculation
- Flow Meter View software and mobile interface for configuration
- Available with electronic valve, with or without control
- Analog control and feedback for data acquisition
- Direct and remote setpoint control
- Built-in high/low flow alarms
- Flow totalizing

Common Gases:

- Natural Gas
- Propane
- Air
- Hydrogen
- Dissociated Ammonia
- Exothermic Gas
- Endothermic Gas
- Methane
- Nitrogen
- Other Industrial Gases

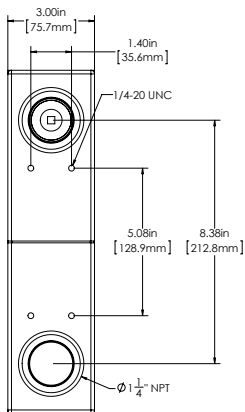

Benefits:

- Compact footprint
- NIST-traceable calibration
- Onboard datalogging (LCD)
- Precision flow measurement
- USB and Bluetooth configuration tools
- Mobile-friendly and web-based remote configuration
- Flow calibration can be certified in use for CQI-9 requirements
- Digital display: easy-to-use touch pad and optional touch screen
- SCADA integration: Current Flow, Totalized Flow, Setpoint, Cost Calculation

INNOVATIVE SOLUTIONS WORLDWIDE



Super Systems
incorporated



The eFlo Line:



eFlo 2.0

- LCD or Touchpad
- Compact footprint
- Onboard datalogging (LCD)
- Bluetooth / mobile connectivity
- Up to 10 psi inlet pressure
- 1 1/4" NPT



eFlo-L and eFlo-H

- Specifically designed for high pressure gas and liquid flow applications
- Direct and remote setpoint
- Digital LED display
- Up to 100 psi inlet pressure
- 1/2" NPT



eFlo Totalizer

- High / low alarms
- Real time and totalized flow
- Precision flow measurement
- RS485 / ethernet communication
- Up to 10 psi inlet pressure
- 1/2" to 2" NPT

Specifications (2.0, L/H, Totalizer)

Power Required:	24VDC @ 400mA
Accuracy:	±4%
Turndown Ratio:	6:1
Gas Temp. Limits:	32°F to 150°F [0°C to 65.6°C]
Ambient Temp. Limits:	32°F to 150°F [0°C to 65.6°C]
Flow Output Signal (Linear):	4-20mA
Max. Output Signal Load:	500Ω
Input Control Signal (Linear):	4-20mA
Response Time:	1 - 10 seconds
Communications:	RS232, RS485, Ethernet, USB
Communications Protocol:	Modbus RTU, Modbus TCP



eFlo Gauge Meter

- Optional manual valve
- Easy to read flow indicator
- Horizontal or vertical mounting
- No moving parts: maintenance-free
- Up to 90 psi inlet pressure
- 1 1/4" or 2" NPT

Specifications (Gauge Meter)

Power Required:	NA
Accuracy:	±4%
Ambient Temp. Limits:	32°F to 150°F [0°C to 65.6°C]
Gas Temp. Limits:	32°F to 150°F [0°C to 65.6°C]



SuperSystems
incorporated

7205 Edington Drive
Cincinnati, OH 45249
513.772.0060 **phone**
513.772.9466 **fax**

www.supersystems.com